

Cliffton Villas, Grange Road, Rhyl

£105,000

🛏 2 🚿 1 🚗 1



An opportunity has arisen to purchase this well presented two bedroom ground floor apartment being well positioned for Rhyl's main town centre with all its shops and public services, seafront and promenade. Having allocated parking space with small front garden area.

Directions: Proceed away from the Rhyl office over the Grange Road bridge onto Grange Road and the apartments can be found on the right hand side .

- Leasehold property
- Can be described as ready to walk into
- EPC - D
- Allocated parking
- Building insurance £130.00 PA
- Well presented throughout
- Close to town centre, seafront and promenade
- Council tax B
- 999 year lease started in 2000
- Ground rent £20.00 PA

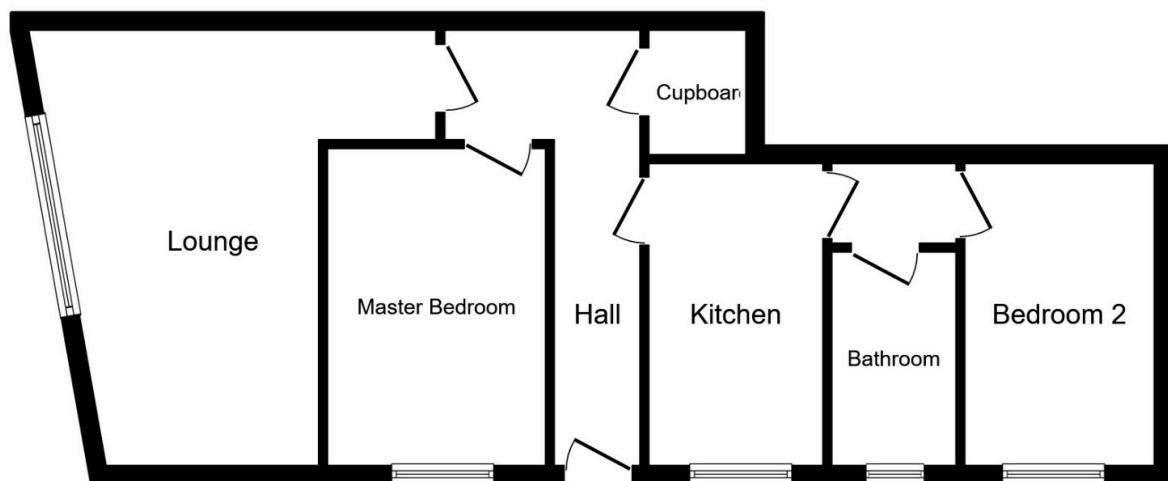

Floor Plan

This floor plan is for illustration purposes only and may not be representative of the property. The position and size of doors, windows and other features are approximate. Unauthorized reproduction prohibited. © PropertyBOX